

Stud Mount Cable Ties

Two-Piece Stud Mount Ties

Unique, two-piece design allows routing to be above, parallel or perpendicular to stud. This also enables up to three separate bundles to be fastened to the same stud. With their low insertion force and high extraction performance, HellermannTyton mounting ties offer the ideal combination of high-grade materials and superior design to suit the mounting and bundling needs of complex applications. Available in standard and high-heat material options.

Features and Benefits

- Versatile design allows cable routing above, perpendicular or parallel to stud.
- Can mount up to three bundles simultaneously, making efficient use of a single mounting point.
- Four-pawl, three-tooth design delivers outstanding stud retention to keep bundles secure.
- PA46 material option allows use in high-heat applications.

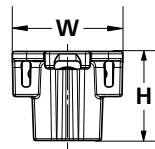
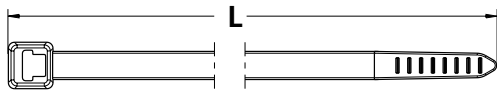

PART NO.	TYPE	Stud Dia. in.	Stud Dia. (mm)	Min. Tensile Strength lbs. (N)	Length (L) in. (mm)	Max. Bundle Diameter in. (mm)	Width (W) in. (mm)	Material Cable Tie	Material Stud Mount	Color	Pkg. Qty.
156-01547	T50R0SB55-6U-SET	0.20, 0.24	(5.0, 6.0)	50.0 (223.0)	8.0 (202.0)	2.0 (50.0)	0.9 (23.3)	PA66HS	PA66HIRHS	Black	3000
156-01668	T50R1SB5-6USET	0.20, 0.24	(5.0, 6.0)	50.0 (223.0)	8.0 (202.0)	2.0 (50.0)	0.9 (23.3)	PA46	PA46	Gray, Brown	3000
156-02232	PAT100LSB55-6U2SET	0.20, 0.24	(5.0, 6.0)	50.0 (223.0)	8.0 (202.0)	2.0 (50.0)	0.9 (23.3)	PPS	PAEK	Silver, Beige	3000

Dimensions are approximate and subject to technical changes. Use Part No. for ordering and Type for specification purposes.
Installation tools: EVO7, EVO7SP, EVO9, EVO9HT, MK7P, MK7HT, MK9P.